

LITE  TOPS

 **MADE IN AMERICA**

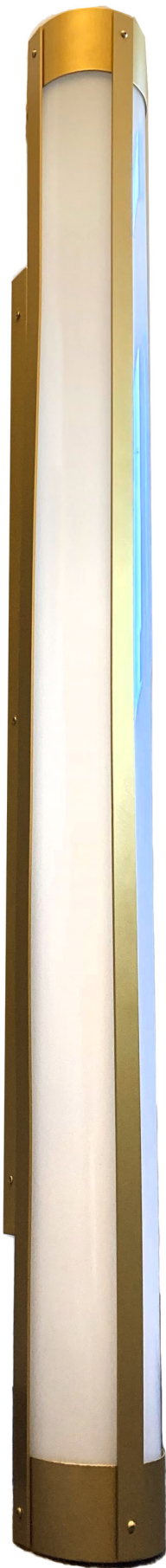







Stiffel CRAFTSMAN

90/1457
city 150

Paraflo

NOTES:

- 1 LITETOP RESERVES THE RIGHTS TO MAKE MINOR CHANGES TO THIS DRAWING AS REQUIRED BY PRODUCTION CONSTRAINTS.
- 2 LITETOP TO DETERMINE WIRING, ASSEMBLY, AND SHIPPING METHOD.

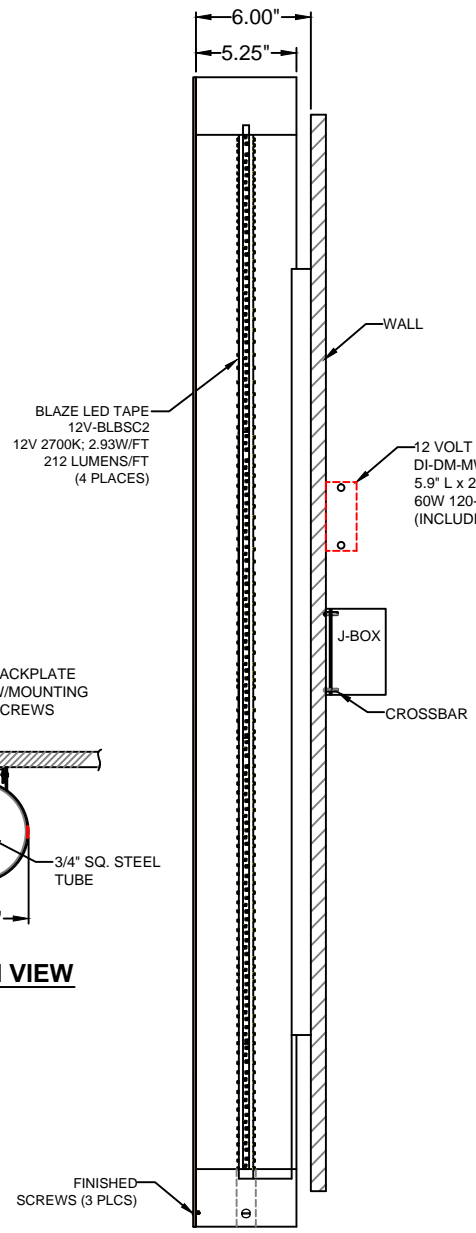
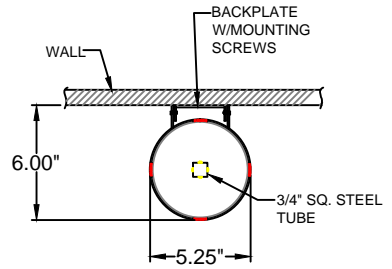
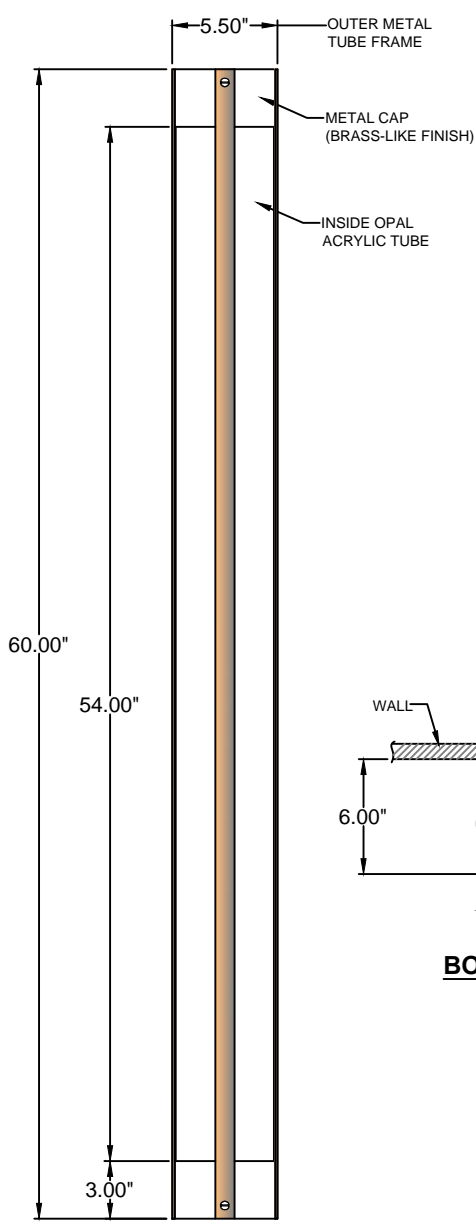

1233 WEST ST. GEORGES AVE.
LINDEN, NJ 07036
908-925-7500 FAX: 908-925-9240

CUSTOMER: JULIE @ WID CHAPMAN ARCHITECTS
JOB NAME: 33rd STREET RESTAURANT
DIMENSIONS: 5.25"W x 60" HT. x 6" D
MATERIAL: METAL & OPAL ACRYLIC TUBE
FINISH: POWDER COATED GOLD
REF:
PO: 155332022
UNITS: 4

DRAWN: RV	CUSTOM LED ACRYLIC SCENCE		REV	
DATE: 12/14/2022			SIZE	DWG NO.:
CHECK PC			A	4401
APPR. PC			SCALE	1
ISSUED	12/16/2022	SHEET: 10F1		

THE INFORMATION CONTAINED IN THIS DRAWING IS THE SOLE PROPERTY OF CUTTING EDGE INDUSTRIES. ANY REPRODUCTION IN PART OR WHOLE WITHOUT THE WRITTEN PERMISSION OF CUTTING EDGE INDUSTRIES WILL BE SUBJECT TO LEGAL PROSECUTION.

Grid lines: 4, 3, 2, 1 (horizontal); D, C, B, A (vertical)

joe kraus lighting 

301-537-5808

joe@joe kraus lighting.com

www.joe kraus lighting.com